

# Product Details

## 750 Gallon Pump Tank

### Model: 750PT

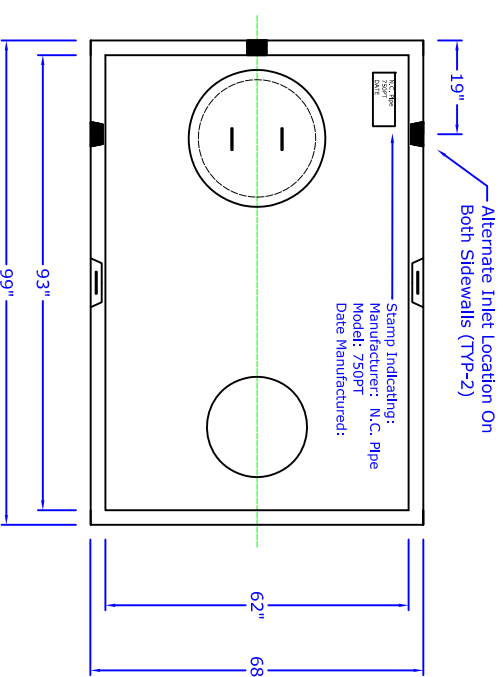

**PLAN VIEW**

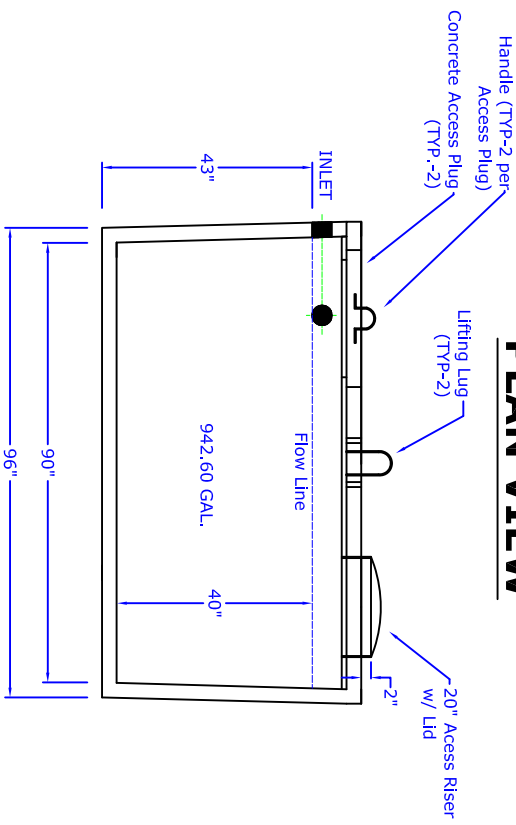

**ELEVATION VIEW**

**CONSTRUCTION NOTES:**

- Designation:** ASTM C 1227, Title 30 Texas Administrative Code chapter 285 and meets all state and local plumbing codes.
- Strength:** Class 1 Concrete, minimum 4000 psi @ 28 days.
- Reinforcement:** Welded wire fabric comply's with ASTM A82, bars conform to ASTM A 615 Grade 60. Bar bending and placement shall comply with the latest ACI Standards. All joints sealed using mastic rope sealant meeting ASTM C 990-91.
- Sealant:** Standard non-traffic duty and built of monolithic construction. Please Consult with N.C. Pipe for traffic-duty requirements.
- Design Loadings:** Standard non-traffic duty and built of monolithic construction. Please Consult with N.C. Pipe for traffic-duty requirements.
- Max. Burial Depth:** 0 to 3' (if deeper installations are required consult with N.C. Pipe)
- Pipe Penetrations:** All pipe penetrations fitted with 4" seals conforming to ASTM C1227 standards.
- Weights:** Bottom Section: 5,340 lbs., Slab Top Section: 2,100 lbs.
- Piping/Baffles:** Inlet/outlet PVC "T" branch fittings/piping optional (not shown for drawing clarity).
- Lifting:** All lifting lugs and handles shall be rated at four times the maximum intended load and meet applicable ASTM standards. Consult with manufacturer prior to lifting. All side walls to be 3".
- Wall Thickness:** 3"

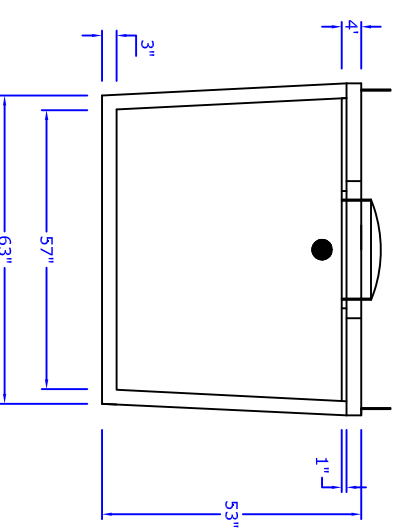

**SIDE VIEW**

Drawn by: A.S.	Scale: 1/4"=1'
4	
3	
2	
1	
0	11/20/2007
REV.	DATE
	DESCRIPTION

**N.C. Pipe Precast Products**  
 9235 Main Street  
 Needville, TX 77461  
 888-331-5871  
 www.ncpipe.com

Dwg. #: OSF750PT-A



" Providing Concrete Environmental Solutions "