

The manhole should be handled with extreme caution to avoid chipping of the spigots or bell groves.

STEP 1

Clean The spigot-end and bell groove of Manhole sections.

STEP 2

Stretch RFS Gasket and place firmly against the offset all the way around the spigot of the manhole.

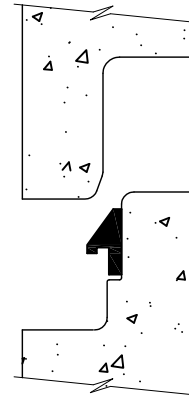

(Fig. A)

NO LUBRICATION NEEDED

The RFS Prelubricated Gasket has all the lubricant it needs inside the sealed mantle. Joints slide together quickly and easily.

SELF-CENTERING DESIGN

The RFS Prelubricated Gasket requires no equalization. It automatically adjusts during application and then helps center the joint during assembly.

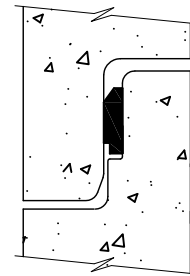

(Fig. B)

STEP 3

Push the manhole section carefully, until the spigot is all the way home. Mantle moves into recess behind gasket, cushioning the joint to deflect. (Fig. B)



9235 Main Street #1
P.O. Box 507
Needville, Texas, 77461
1-888-331-5871

"Providing Concrete Environmental Solutions"

MANHOLE O-RING INSTALLATION INSTRUCTIONS

Date: 16 JUL 2012

File: NC_JOINT

Scale: 6"=1'-0"

* All Dimensions subject to allowable specification tolerances.

Approved By: _____

Date: _____