

CAST IRON ASTM A-48 CLASS 30B

NOTE:
(OPTIONAL)
CAST IRON ADA GRATE & SOLID COVER AVAILABLE

NOTE:
ADDITIONAL FRAME & GRATE SIZES AVAILABLE

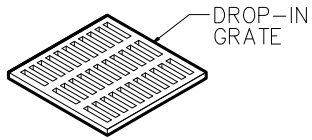

DROP-IN GRATE

CAST IRON GRATE
38" X 38"
OPEN AREA - 631 SQ/IN
WEIGHT - 470 LBS

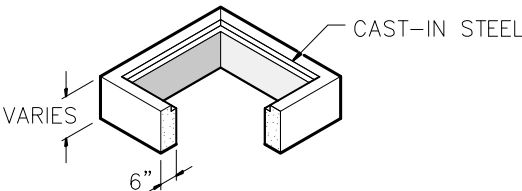

CAST-IN STEEL

36" X 36" I.D.
RISER SECTION (OPTIONAL)
6" HEIGHT - 525 LBS
12" HEIGHT - 1050 LBS
24" HEIGHT - 2100 LBS

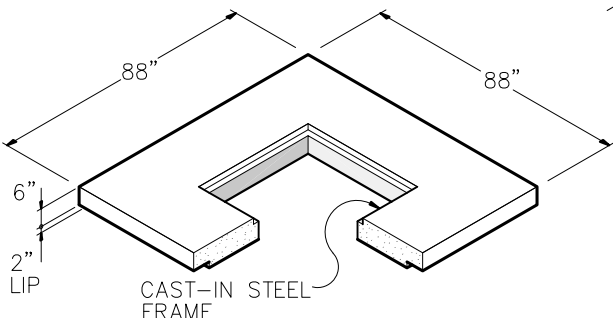

CAST-IN STEEL FRAME

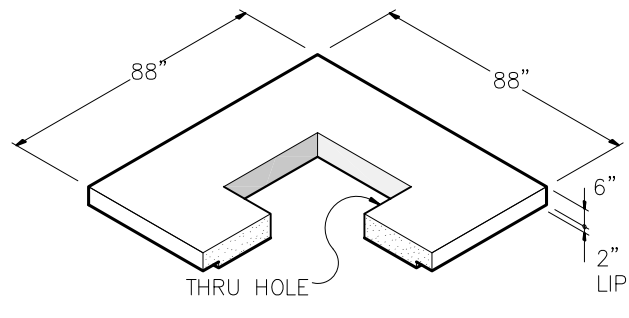

THRU HOLE

SLAB TOP W/
CAST IN STEEL FRAME
WEIGHT - 4500 LBS

REINFORCEMENT (SLAB TOP)
#5 BARS @ PERIMETER OF THRU HOLE
#5 BARS @ 6" O.C.E.W.

SLAB TOP W/
36" X 36" OPENING (OPTIONAL)
WEIGHT - 4500 LBS

REINFORCEMENT (SLAB TOP)
#5 BARS @ PERIMETER OF THRU HOLE
#5 BARS @ 6" O.C.E.W.

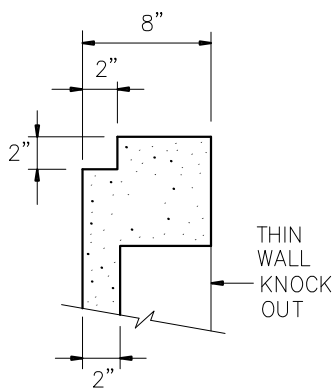

THIN WALL KNOCK OUT

TYP. WALL DETAIL
72" X 72"

NOTE:
OPTIONAL BOX RISER AVAILABLE

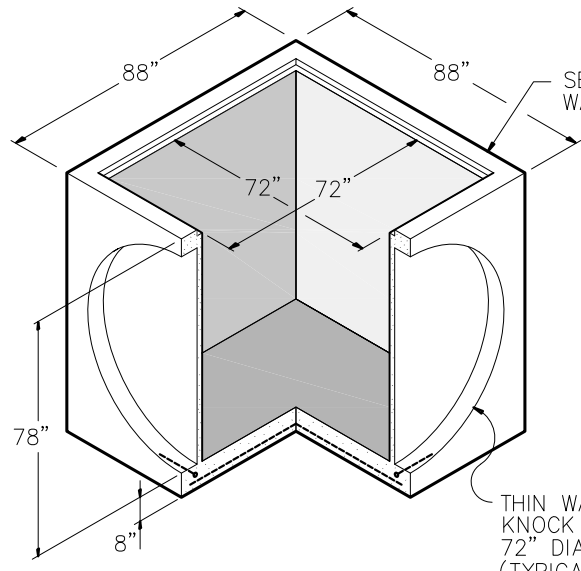

BASE SECTION
72" X 72" I.D.
WEIGHT - 19,440 LBS

REINFORCEMENT (BASE)
#5 BARS AROUND PERIMETER OF BASE
#5 BARS @ 12" O.C.E.W. FLOOR

- GENERAL NOTES:**
- DESIGN SHALL MEET OR EXCEED EXCEED ASTM C-913 SPECIFICATIONS
 - 4500 PSI CONCRETE AT 28 DAYS
 - ATSM A615, GRADE 60 REINFORCING
 - HS 20 LOADING
 - ALL JOINT CONNECTIONS TO BE GROUTED PER SPECS.



9235 Main Street #1
P.O. Box 507
Needville, Texas, 77461
1-888-331-5871

"Providing Concrete Environmental Solutions"

72" X 72"
CATCH BASIN

NC-003-010

Scale: 3/16"=1'-0"
* All Dimensions subject to allowable specification tolerances.

Date: 04/10/18

Rev Date: 10/18/18

Approved By: _____ Date: _____